

- NOTES & RESERVATIONS**
1. This Property is Subject To Any And All Right-of-way, Appurtenances, Restrictions And Or Easements In Effect To Date.
 2. All Set Corners Are 1/2" X 18" Steel Rebar With Identifier Cap Stamped "D.L. Clemons / Pls #3383".
 3. Adjoining Property Owners Are Shown According To Property Valuator's Office.
 4. Surveyor Has Made No Investigation Or Independent Search For Easements Or Record Encumbrances, Restrictive Covenants, Ownership Title Evidence, Or Any Other Facts That An Accurate And Current Title Search May Disclose.
 5. The certification of this Survey is made as of this date only for the person it was done for and is subject to any future facts that may more accurately describe or establish the boundary shown hereon. This survey is subject to any adverse or other rights of Others Due To Court Action.
 6. This survey does not represent or establish land ownership per 201 KAR 18:150 3(2)(a).
 7. All bearings and coordinates are on Kentucky State Plane Single Zone, Geoid 2016 was used. All distances are grid distances unless noted.



- LEGEND**
- 1/2" X 18" STEEL REBAR SET WITH ID CAP #3383
 - 1/2" STEEL REFERENCE REBAR SET WITH ID CAP #3383
 - 1/2" STEEL REFERENCE REBAR FOUND WITH ID CAP #3383
 - 3/8" STEEL REBAR FOUND WITH NO ID CAP
 - 48" BLACK OAK
 - CALCULATED MEANDER POINTS

LINE	BEARING	DISTANCE
L1	N 74°41'59" W	66.97'
L2	N 15°43'58" W	60.32'
L3	N 18°30'04" W	123.31'
L4	N 26°22'36" W	65.15'
L5	N 37°59'43" W	119.06'
L6	S 29°33'04" W	69.44'
L7	S 29°33'04" W	110.58'
L8	S 29°33'04" W	139.83'
L9	S 29°33'04" W	131.95'
L10	S 29°33'04" W	143.09'
L11	S 29°33'04" W	63.51'
L12	S 04°30'57" W	58.67'
L13	S 03°02'53" E	42.58'
L14	S 19°39'19" E	44.09'
L15	S 28°51'00" E	37.65'
L16	S 35°42'57" E	31.39'
L17	S 39°28'29" E	36.63'
L18	S 40°43'12" E	20.64'
L19	S 40°43'12" E	52.95'
L20	S 42°39'16" E	38.44'
L21	S 42°41'12" E	43.42'
L22	S 46°19'48" E	51.82'
L23	S 43°21'22" E	18.89'
L24	S 43°18'14" E	16.34'
L25	S 40°43'12" E	19.97'
L26	S 42°14'23" E	21.65'
L27	S 28°51'00" E	11.34'
L28	S 29°33'04" W	23.89'
L29	S 12°22'56" E	23.89'
L30	S 08°08'15" E	21.23'
L31	S 08°08'15" E	12.83'
L32	S 02°18'46" W	21.82'
L33	S 08°13'44" W	29.21'
L34	S 05°56'19" W	14.78'
L35	S 09°40'03" W	16.73'
L36	S 12°50'11" W	24.07'
L37	S 15°22'43" W	28.06'
L38	S 16°54'59" W	36.32'
L39	S 17°08'14" W	8.89'
L40	S 17°08'14" W	8.20'
L41	S 17°23'28" W	36.53'
L42	S 17°23'28" W	36.32'
L43	S 17°23'28" W	26.29'
L44	S 17°23'28" W	17.73'
L45	S 16°49'14" W	60.63'
L46	S 17°00'20" W	74.22'
L47	S 16°09'28" W	80.16'
L48	S 16°58'48" W	76.90'
L49	S 16°19'41" W	16.63'
L50	S 16°53'11" W	84.80'
L51	S 16°09'32" W	17.44'
L52	S 15°29'10" W	26.03'
L53	S 14°22'16" W	42.28'
L54	S 15°59'11" W	29.42'
L55	S 16°30'23" W	26.00'
L56	S 16°30'23" W	23.89'
L57	S 17°58'49" W	23.75'
L58	S 16°00'13" W	22.00'
L59	S 16°59'10" W	16.83'
L60	S 17°23'31" W	26.72'
L61	S 16°48'54" W	25.09'
L62	S 16°54'43" W	28.06'
L63	S 16°59'56" W	24.11'
L64	S 16°31'02" W	24.44'
L65	S 16°24'23" W	51.22'
L66	S 16°00'21" W	26.33'
L67	S 16°14'21" W	22.22'
L68	S 16°00'18" W	34.46'
L69	S 16°20'57" W	44.07'
L70	S 16°00'51" W	29.12'
L71	S 16°16'15" W	122.86'
L72	S 16°48'22" W	17.34'
L73	S 16°39'29" W	16.63'
L74	S 16°07'45" W	29.84'
L75	S 16°05'42" W	32.80'
L76	S 16°58'03" W	40.36'
L77	S 16°00'21" W	84.12'
L78	S 14°02'14" W	23.64'
L79	S 14°02'14" W	100.65'
L80	S 14°02'14" W	100.65'
L81	S 14°48'53" W	36.74'
L82	S 14°48'53" W	20.44'
L83	S 14°26'59" W	72.84'
L84	S 14°02'14" W	100.65'
L85	S 13°06'37" W	49.84'
L86	S 13°33'11" W	32.29'
L87	S 13°33'11" W	109.72'
L88	S 12°44'37" E	31.75'
L89	S 65°36'29" W	147.18'
L90	S 61°24'17" W	53.69'
L91	S 49°24'41" W	13.42'
L92	S 16°18'04" W	19.39'
L93	S 02°04'18" E	69.59'
L94	N 88°31'09" W	12.56'

SURVEYOR'S CERTIFICATION

I HEREBY EXCLUSIVELY CERTIFY TO THE PARTIES NAMED HEREON THAT THIS PLAT DEPICTS A SURVEY MADE BY ME OR UNDER MY DIRECT SUPERVISION BY THE METHOD OF "RTK" GPS MEASUREMENT. THIS SURVEY WAS PERFORMED USING DUAL FREQUENCY JAVAD TRIUMPH L/S GPS EQUIPMENT. THIS SURVEY IS AN URBAN SURVEY AND MEETS ALL OF THE ACCURACY & PRECISION SPECIFICATIONS OF THIS CLASS. THE RELATIVE POSITIONAL ACCURACY OF EACH MONUMENT IS ±0.04" (100PPM) AT THE 95% CONFIDENCE LEVEL. THE ANGULAR & LINEAR MEASUREMENTS HAVE NOT BEEN ADJUSTED FOR CLOSURE AND ARE CORRECT TO THE BEST OF MY KNOWLEDGE AND BELIEF. I ALSO CERTIFY THAT ALL MONUMENTS INDICATED HERE DO ACTUALLY EXIST AND THAT THEIR LOCATIONS, SIZES AND MATERIALS ARE CORRECTLY INDICATED. I ALSO CERTIFY THAT THIS SURVEY AND PLAT COMPLY WITH 201 KAR 18:50. HORIZONTAL DATUM - NAD '83. VERTICAL DATUM - NAVD83. GEOID MODEL - GEOID '18.

SIGNATURE _____ DATE _____
 REGISTRATION NUMBER _____

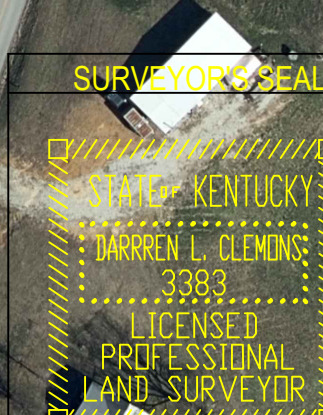

OWNERS CERTIFICATION

I, (WE) HEREBY CERTIFY THAT I AM (WE ARE) THE OWNER(S) OF THE PROPERTY SHOWN HEREON AND THAT I (WE) HEREBY ADOPT THIS PLAN OF SUB-DIVISION WITH MY (OUR) FREE CONSENT AND ESTABLISH THE EASEMENTS AND ROAD RIGHTS-OF-WAYS AS SHOWN.

OWNER _____ DATE _____

RECORD PLAT OF _____ COMPLIES WITH 201 KAR 18:150.

JASON HUMPHREY PROPERTY

CLIENT: KY LAND	OWNER: JASON LEROY HUMPHREY
SCALE: 1" = 100'	SOURCE OF TITLE: DB:57 PG:617 / EQUINUS GRAYSON
AREA: 37.229 ACRES	DATE: 3-18-2025
DISTANCES: GPS	DRAWN BY: LMM
	APPROVED BY: [Signature]



CLEMONS & ASSOCIATES
LAND SURVEYING, INC.

522 NORTH MULBERRY
ELIZABETHTOWN, KY, 42701
PHONE: (270) 766-1112
darren3383@bhtel.com